

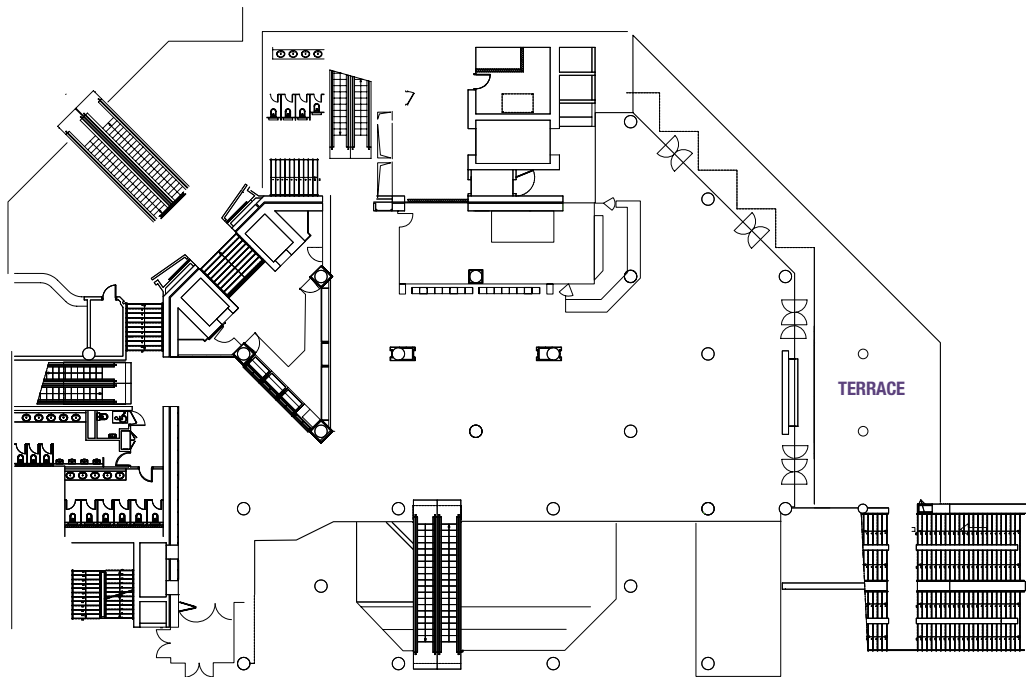





INDIGO

EXHIBITION AND CATERING SPACE

A BRAND NEW 800 M² SPACE WITH AN EXCEPTIONAL PANORAMIC SEA VIEW TERRACE!
ELEGANT AND FLEXIBLE, THE INDIGO IS THE PLACE TO HOST YOUR LUNCHES, GALA DINNERS,
COCKTAIL PARTIES UP TO 560 STANDING GUESTS AND VIP EVENINGS.



- 
Surface area:
 Room **620 m²** (6,674 sq.ft)
 Terrace **170 m²** (1,830 sq.ft)
 Caterer area **60 m²** (645 sq.ft)
- 
Catering: 456 seated guests
 (round tables)
- 
Cocktail parties: 558 standing guests
- 
Exhibition: 201 m² net (2,164 sq.ft)
 Optimised setup
 16 booths of 9 m² (97 sq.ft)
 + 8 booths of 6 m² (65 sq.ft)
 + 2 booths of 4.5 m² (48 sq.ft)

Technical features

- **Level +1**
- Height: around 2.55 m (8.4 ft)
- 1 goods lift for deliveries and direct access way from the street
- Terrace, panoramic view on the Mediterranean sea
- Caterer area

scale in m

