

SALLES PATIO

SURFACE/ SURFACE AREA

- Surface totale : **1 316 m²**
et jardins du patio : **390 m²**
- Hauteur sous plafond : **2.50 m - 3.40 m**

- Total area: 1,316 m²
and patio gardens : 390 m²
- Ceiling height: 250 m - 340 m

CAPACITÉ/ CAPACITY

- Exposition : **63 modules de 9m²**
- Salles de comissions : jusqu'à 7 salles de 44 à 80 pax
- Maximum capacity : 517 pax

- Exhibition: 63 booths of 9m² each
- Breakout rooms: up to 7 rooms from 44 to 80 pax
- Capacité maximum : 517 pax

LIVRAISON/ DELIVERY

- Accès depuis la zone logistique E3 via la Galerie Diaghilev (sous conditions)
- Accès depuis le MC1 via Diaghilev (sous conditions)
- Charge maximale au sol : 500 Kg/m²

- Access from the logistic zone E3 by the Diaghilev Gallery (on condition)
- Access from the MC1 by Diaghilev (on condition)
- Maximum floor loading: 500 Kg/m²

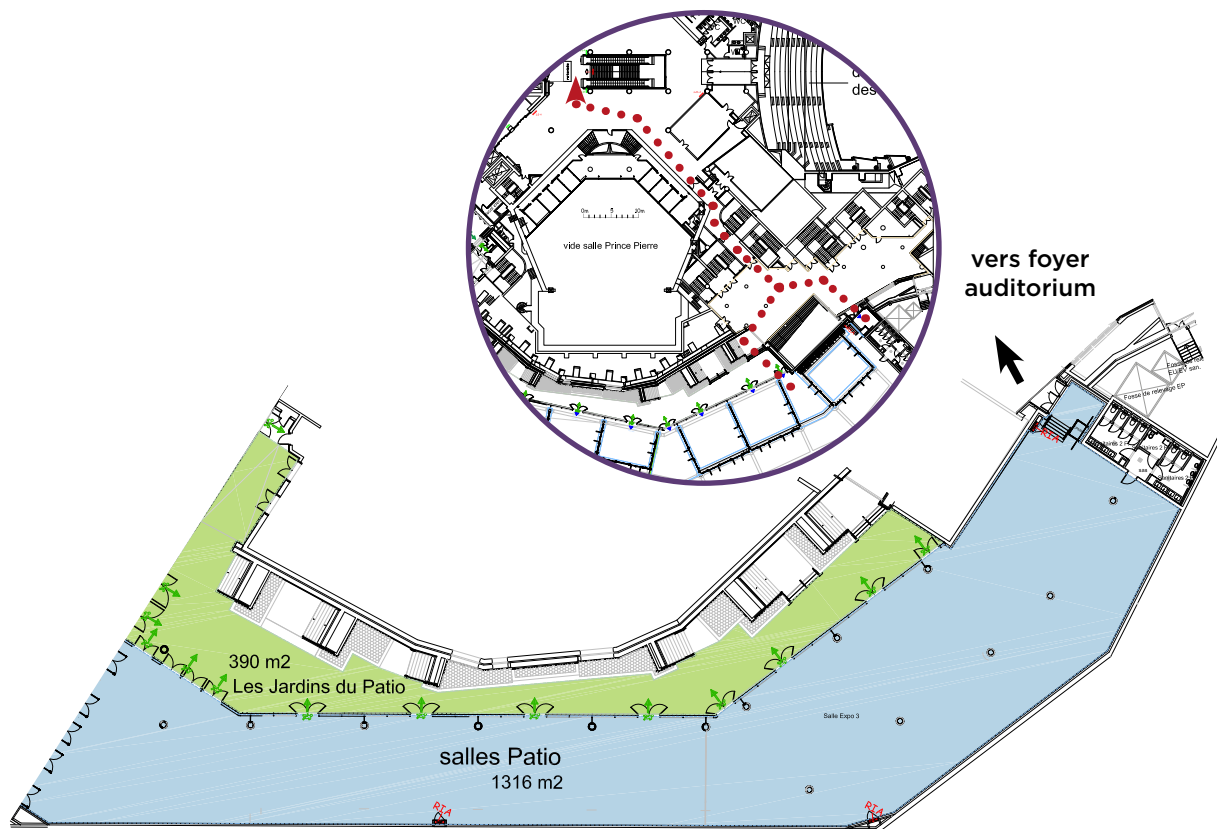

PLAN SÉCURITÉ ET HAUTEURS SOUS PLAFOND / SECURITY AND HEIGHT PLAN

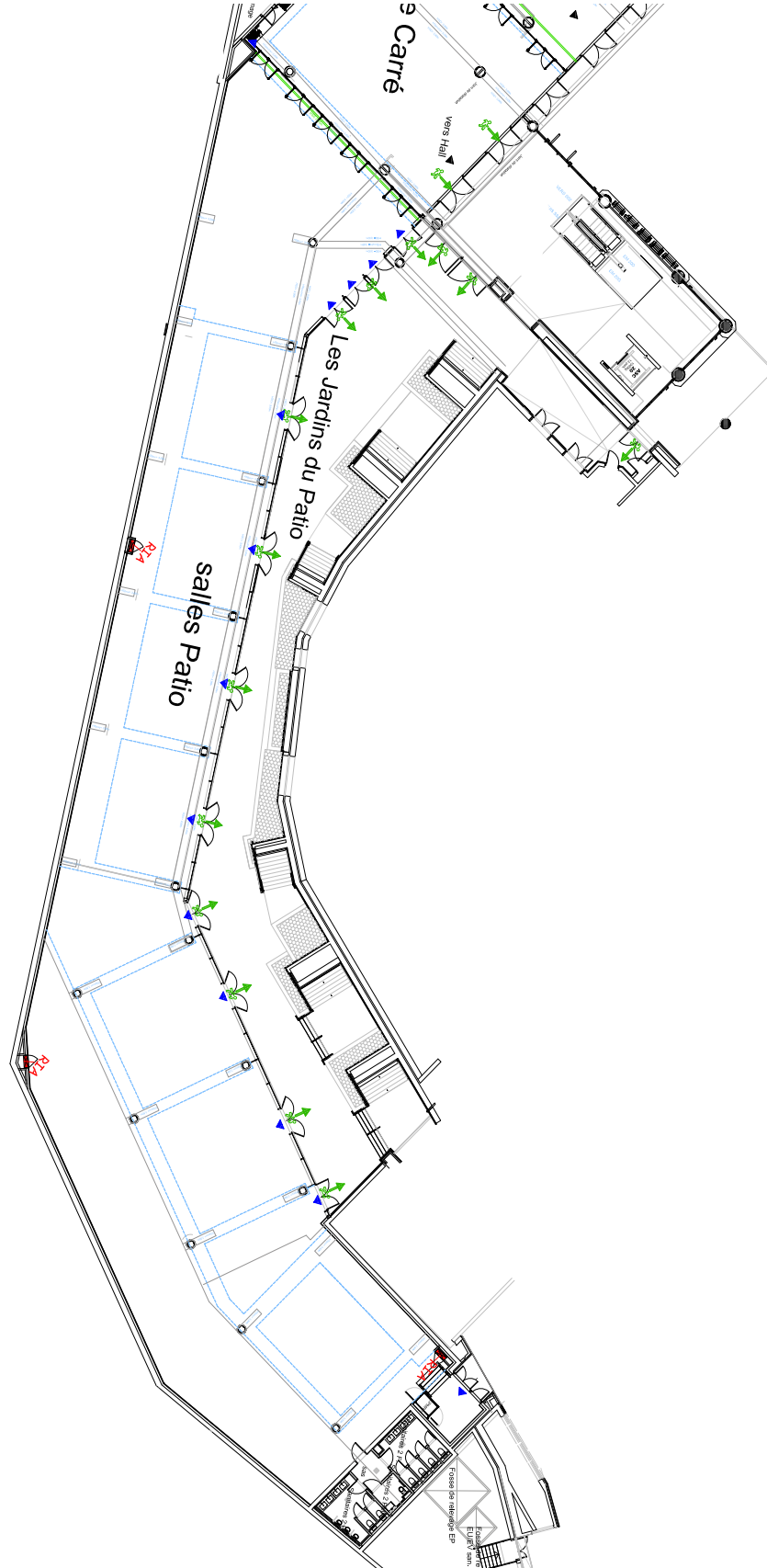

AMÉNAGEMENT EXPOSITION / EXHIBITION USE

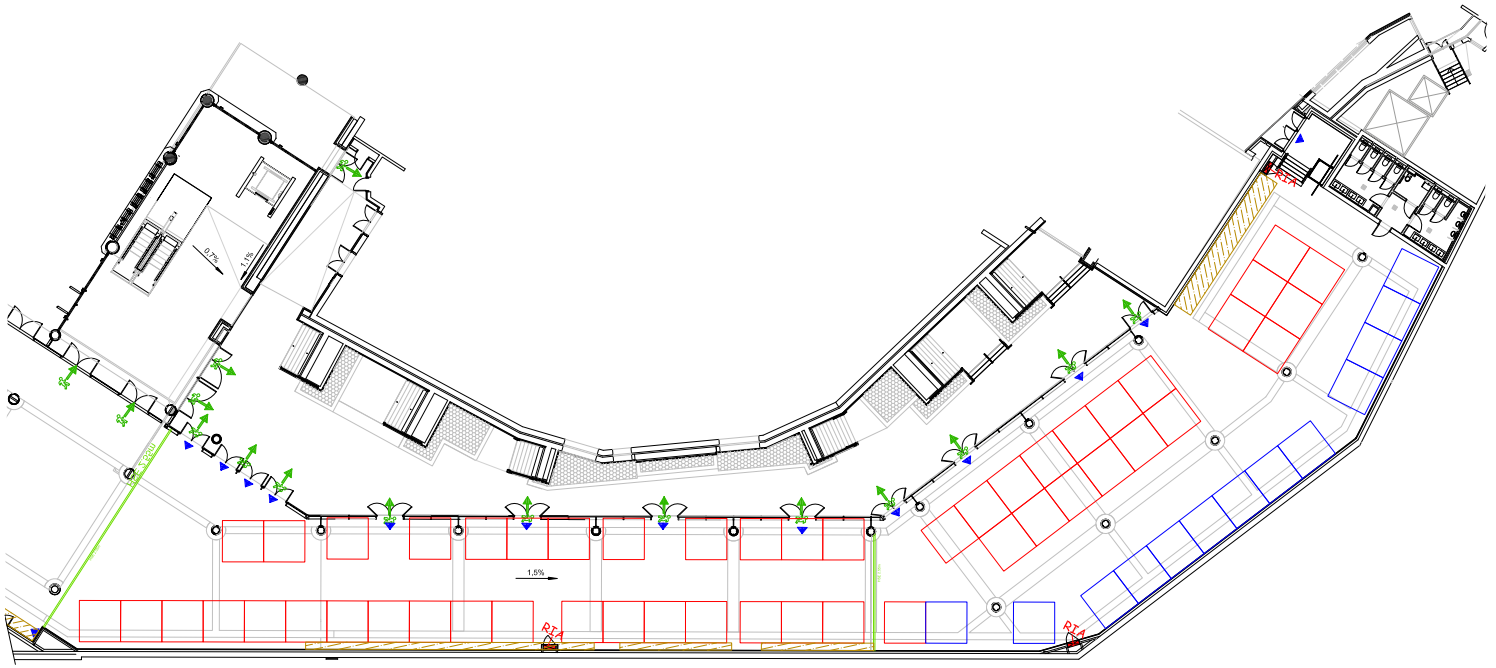

- 63 modules de 9 m²
- 63 modules of 9 m²

PRESTATIONS INCLUSES / INCLUDED SERVICES

Nettoyage journalier des allées et parties communes (hors stand) /
Aisles daily cleaning and common areas (excluding stand)



Éclairage de base de la salle, chauffage ou climatisation /
Basic room lighting, heating or cooling



AMÉNAGEMENT RÉUNIONS ET CONFÉRENCES / MEETING AND CONFERENCE USE

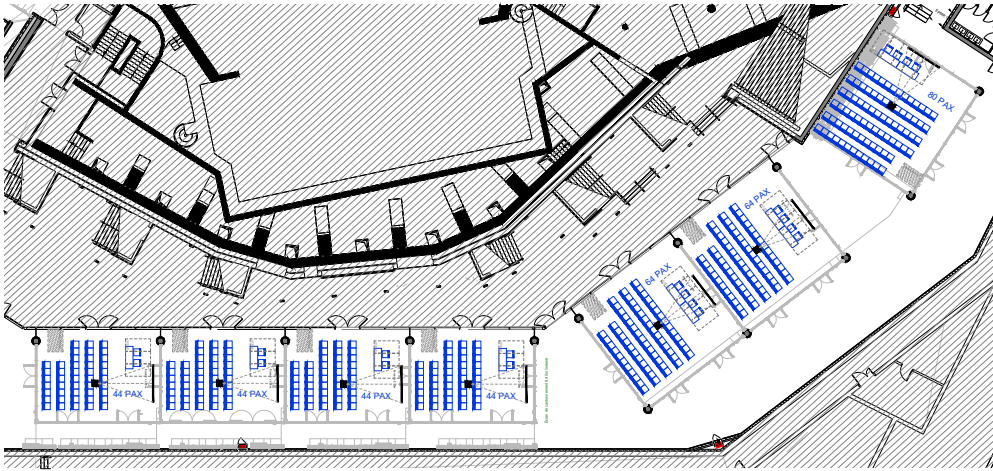

- Style théâtre : 384 pax
- Theatre style: 384 pax

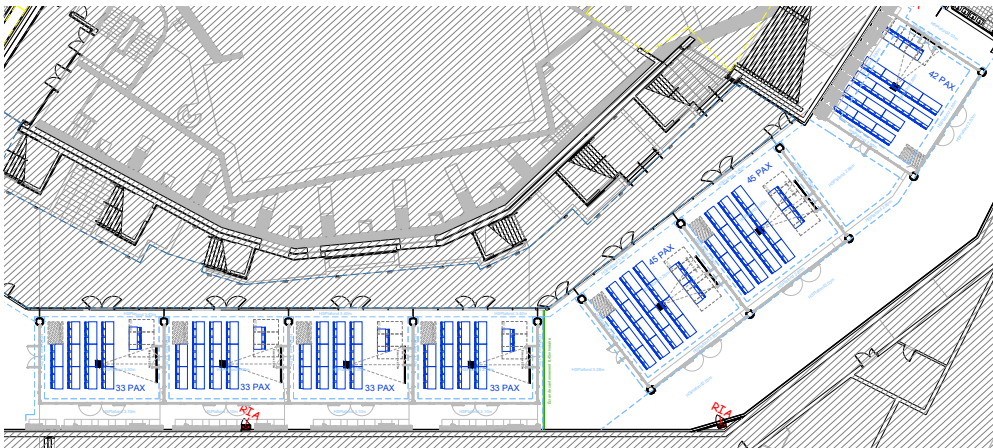

- Style école : 264 pax
- School style: 264 pax

PRESTATIONS INCLUSES / INCLUDED SERVICES

	< 50 pax	50 pax - 200 pax
Écran / Screen	-	✓
Éclairage salle / room lighting	✓	✓
Chaises (théâtre) / Chairs (theatre)	✓	✓
Tables, chaises en tribunes / Tables, chairs for speakers in tribune	✓	✓
Eau en tribune / Water for speakers	✓	✓
Pupitre / Speaker stand	-	✓
Sonorisation de base (3 micros fil sans technicien) / Basic sound system (3 wired mics without technician)	-	✓
Podium / Podium	-	✓
1 Technicien son / 1 Sound technician	-	✓
Paperboard / Paperboard	✓	-